

CRAZY
T R E N D

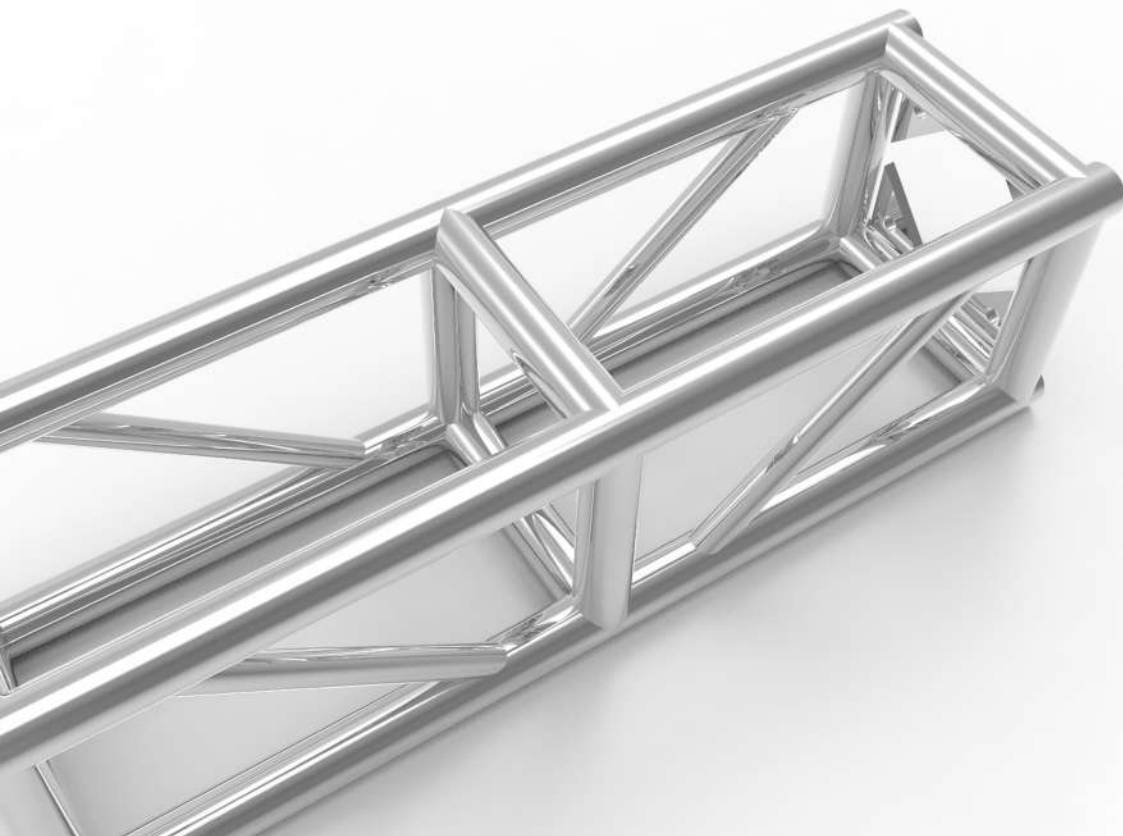

M 220



TECHNICAL DATA

Pipe diameter	35mm
Wall thickness	1,6mm
Brace diameter	
Material	Aluminum 6068-T2
Connectors	Spigot

220 LADDER

Span	m (ft)	3.00 (9.84)	4.00 (13.12)	5.00 (16.40)	6.00 (19.69)	7.00 (22.97)	8.00 (26.25)	9.00 (29.53)
Point load	kg (lbs)	198.7 (438.05)	167.2 (368.6)	144.4 (318.3)	127.0 (279.9)	---	---	---
Deflection	mm (in)	5 (0.19)	11 (0.43)	14 (0.55)	29 (1.14)	---	---	---
Distrib. loading	kg (lbs)	69.7 (153.6)	52.0 (114.6)	41.4 (91.2)	34.3 (75.6)	---	---	---
Deflection	mm (in)	5 (0.19)	10 (0.39)	16 (0.62)	30 (1.18)	---	---	---

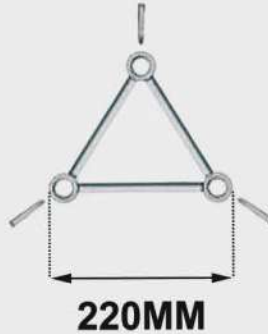

TECHNICAL DATA

Pipe diameter	35mm
Wall thickness	1.6mm
Brace diameter	
Material	Aluminum 6068-T2
Connectors	Spigot

220 TRIANGLE

Span	m (ft)	4.00 (13.12)	6.00 (19.69)	8.00 (26.25)	10.00 (32.81)	12.00 (39.37)	14.00 (45.93)	16.00 (52.49)
Point load	kg (lbs)	132.1 (291.2)	99.1 (218.4)	79.3 (174.8)	66.1 (145.7)	---	---	---
Deflection	mm (in)	8 (0.31)	21 (0.82)	41 (1.61)	67 (2.63)	---	---	---
Distrib. loading	kg (lbs)	90.5 (199.5)	40.7 (89.7)	22.5 (49.6)	14.0 (30.8)	---	---	---
Deflection	mm (in)	14 (0.55)	33 (1.29)	58 (2.28)	88 (3.46)	---	---	---

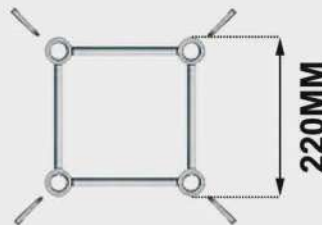

TECHNICAL DATA

Pipe diameter	35mm
Wall thickness	1.6mm
Brace diameter	
Material	Aluminum 6068-T2
Connectors	Spigot

220 SQUARE

Span	m (ft)	4.00 (13.12)	6.00 (19.69)	8.00 (26.25)	10.00 (32.81)	12.00 (39.37)	14.00 (45.93)	16.00 (52.49)
Point load	kg (lbs)	135.3 (298.2)	102.8 (226.6)	82.8 (182.5)	69.4 (153)	---	---	---
Deflection	mm (in)	4 (0.15)	11 (0.43)	21 (0.82)	35 (1.37)	---	---	---
Distrib. loading	kg (lbs)	99.2 (218.6)	45.9 (101.1)	26.2 (57.7)	16.9 (37.2)	---	---	---
Deflection	mm (in)	8 (0.31)	19 (0.74)	34 (1.33)	53 (2.08)	---	---	---

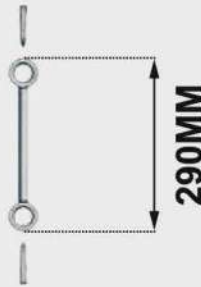

TECHNICAL DATA

Pipe diameter	50mm
Wall thickness	2,0mm
Brace diameter	20mm
Material	Aluminum 6068-T2
Connectors	Spigot

290 LADDER

Span	m (ft)	3.00 (9.84)	4.00 (13.12)	5.00 (16.40)	6.00 (19.69)	7.00 (22.97)	8.00 (26.25)	9.00 (29.53)
Point load	kg (lbs)	586.2 (1292.34)	501.0 (1104.5)	398.1 (877.6)	329.0 (725.3)	279.2 (615.5)	241.5 (532.4)	211.8 (466.9)
Deflection	mm (in)	5 (0.19)	11 (0.43)	17 (0.66)	24 (0.94)	32 (1.25)	42 (1.65)	54 (2.12)
Distrib. loading	kg (lbs)	377.0 (831.1)	250.5 (552.2)	159.2 (350.9)	109.7 (241.8)	79.8 (175.9)	241.5 (133.1)	47.1 (103.8)
Deflection	mm (in)	6 (0.23)	13 (0.51)	21 (0.82)	30 (1.18)	40 (1.57)	51 (2.00)	69 (2.71)

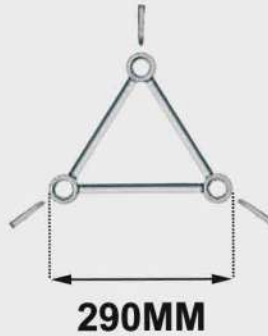

TECHNICAL DATA

Pipe diameter	50mm
Wall thickness	2,0mm
Brace diameter	20mm
Material	Aluminum 6068-T2
Connectors	Spigot

290 TRIANGLE

Span	m (ft)	4.00 (13.12)	6.00 (19.69)	8.00 (26.25)	10.00 (32.81)	12.00 (39.37)	14.00 (45.93)	16.00 (52.49)
Point load	kg (lbs)	411.4 (906.9)	279.3 (615.7)	202.5 (446.4)	154.8 (341.2)	121.6 (268.0)	96.9 (213.6)	77.3 (170.4)
Deflection	mm (in)	9 (0.35)	21 (0.82)	37 (1.45)	58 (2.28)	84 (3.30)	114 (4.48)	148 (5.82)
Distrib. loading	kg (lbs)	215.0 (473.9)	93.1 (205.2)	50.6 (111.5)	31.0 (68.3)	20.3 (44.7)	13.8 (30.4)	10.0 (22.0)
Deflection	mm (in)	13 (0.51)	26 (1.02)	47 (1.85)	73 (2.87)	105 (4.13)	143 (5.62)	164 (6.45)

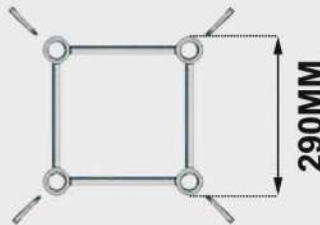

TECHNICAL DATA

Pipe diameter	50mm
Wall thickness	2,0mm
Brace diameter	20mm
Material	Aluminum 6068-T2
Connectors	Spigot

290 SQUARE

Span	m (ft)	4.00 (13.12)	6.00 (19.69)	8.00 (26.25)	10.00 (32.81)	12.00 (39.37)	14.00 (45.93)	16.00 (52.49)
Point load	kg (lbs)	629.0 (1386.7)	520.8 (1148.1)	444.3 (979.5)	385.2 (849.2)	313.6 (691.3)	261.4 (576.2)	221.2 (487.6)
Deflection	mm (in)	8 (0.31)	17 (0.66)	39 (1.53)	65 (2.55)	93 (3.66)	119 (4.68)	151 (5.94)
Distrib. loading	kg (lbs)	502.5 (1107.8)	221.0 (487.2)	122.0 (268.9)	76.0 (167.5)	51.0 (112.4)	36.0 (79.3)	27.0 (59.5)
Deflection	mm (in)	12 (0.47)	30 (1.18)	52 (2.04)	80 (3.14)	111 (4.37)	161 (6.33)	213 (8.38)

M 400

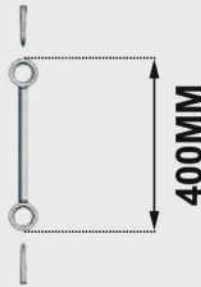
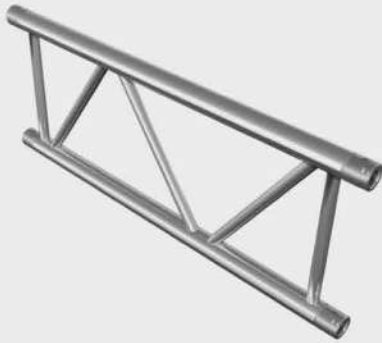

TECHNICAL DATA

Pipe diameter	50mm
Wall thickness	2,0mm
Brace diameter	20mm
Material	Aluminum 6068-T2
Connectors	Spigot

400 LADDER

Span	m (ft)	3.00 (9.84)	4.00 (13.12)	5.00 (16.40)	6.00 (19.69)	7.00 (22.97)	8.00 (26.25)	9.00 (29.53)
Point load	kg (lbs)	491.1 (1082.6)	446.4 (984.1)	409.2 (902.1)	377.7 (832.6)	350.7 (773.1)	327.3 (721.5)	306.8 (676.3)
Deflection	mm (in)	2 (0.07)	5 (0.19)	8 (0.31)	13 (0.51)	19 (0.74)	27 (1.06)	36 (1.41)
Distrib. loading	kg (lbs)	558.3 (1230.8)	366.5 (807.9)	233.5 (514.7)	161.2 (355.3)	117.7 (259.4)	89.4 (197.1)	70.0 (154.3)
Deflection	mm (in)	4 (0.15)	10 (0.39)	15 (0.59)	21 (0.82)	29 (1.14)	37 (1.45)	46 (1.81)

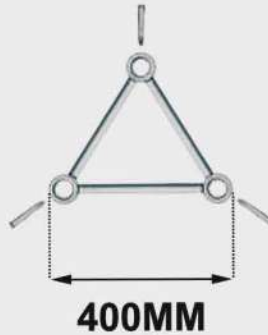
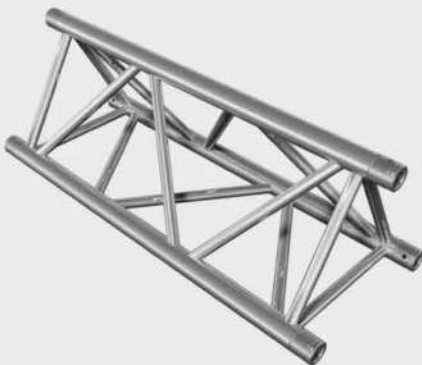

TECHNICAL DATA

Pipe diameter	50mm
Wall thickness	2,0mm
Brace diameter	20mm
Material	Aluminum 6068-T2
Connectors	Spigot

400 TRIANGLE

Span	m (ft)	4.00 (13.12)	6.00 (19.69)	8.00 (26.25)	10.00 (32.81)	12.00 (39.37)	14.00 (45.93)	16.00 (52.49)
Point load	kg (lbs)	385.0 (848.7)	321 (707.6)	275 (606.2)	236 (520.2)	189 (416.6)	155 (341.7)	128 (282.1)
Deflection	mm (in)	4 (0.15)	12 (0.47)	23 (0.90)	38 (1.49)	52 (2.04)	68 (2.67)	83 (3.26)
Distrib. loading	kg (lbs)	316.0 (696.6)	138 (304.2)	76 (167.5)	47 (103.6)	32 (70.5)	22 (48.5)	16 (35.2)
Deflection	mm (in)	10 (0.39)	18 (0.70)	31 (1.22)	50 (1.96)	66 (2.59)	84 (3.30)	104 (4.09)

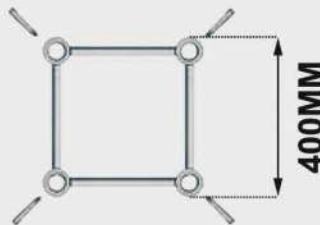
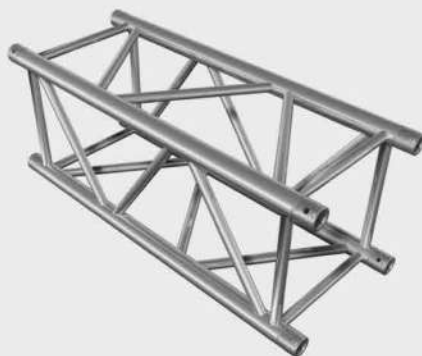

TECHNICAL DATA

Pipe diameter	50mm
Wall thickness	2,0mm
Brace diameter	20mm
Material	Aluminum 6068-T2
Connectors	Spigot

400 SQUARE

Span	m (ft)	4.00 (13.12)	6.00 (19.69)	8.00 (26.25)	10.00 (32.81)	12.00 (39.37)	14.00 (45.93)	16.00 (52.49)
Point load	kg (lbs)	478.4 (1054.6)	430.6 (949.3)	391.6 (863.3)	359.0 (791.0)	331.5 (730.8)	307.8 (678.5)	287.3 (633.3)
Deflection	mm (in)	2.4 (0.09)	7.4 (0.29)	16 (0.62)	28 (1.10)	45 (1.88)	67 (2.63)	93 (3.66)
Distrib. loading	kg (lbs)	518 (1141.9)	324 (714.2)	181 (399.0)	114 (251.3)	78 (171.9)	56 (123.4)	42 (92.5)
Deflection	mm (in)	6.6 (0.25)	20.9 (0.82)	36 (1.41)	57 (2.24)	81 (3.18)	107 (4.21)	137 (5.39)

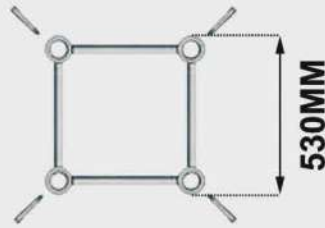
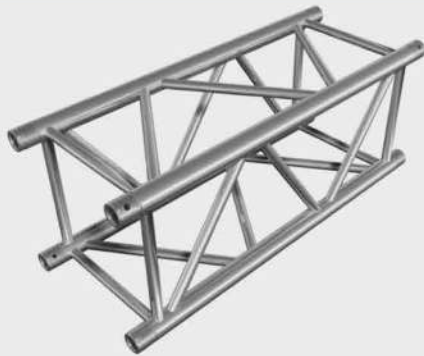

TECHNICAL DATA

Pipe diameter	50mm
Wall thickness	4,0mm
Brace diameter	25x3mm
Material	Aluminum 6068-T2
Connectors	Spigot

530 SQUARE

Span	m (ft)	4.00 (13.12)	6.00 (19.69)	8.00 (26.25)	10.00 (32.81)	12.00 (39.37)	14.00 (45.93)	16.00 (52.49)
Point load	kg (lbs)	2588 (5705.2)	2188 (4823.7)	1635 (3604.5)	1296 (2857.1)	1065 (2347.9)	895 (1972.5)	741 (1633.9)
Deflection	mm (in)	11.2 (0.44)	14.1 (0.60)	25.3 (0.99)	40 (1.60)	58.1 (2.30)	79.9 (3.8)	102.7 (4.0)
Distrib. loading	kg (lbs)	897 (1977.5)	729 (1607.1)	409 (901.6)	259 (570.9)	117 (257.9)	128 (282.1)	93 (205.0)
Deflection	mm (in)	16.6 (0.65)	20.9 (0.82)	30.3 (1.20)	47.9 (1.90)	69.8 (2.70)	95.9 (3.8)	123.3 (4.9)

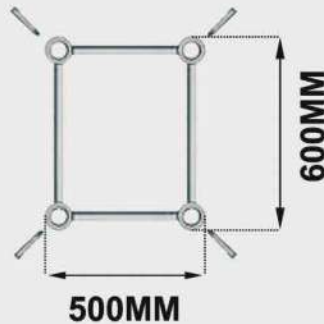
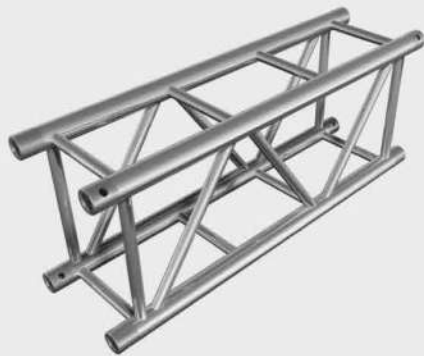

TECHNICAL DATA

Pipe diameter	50mm
Wall thickness	4,0mm
Brace diameter	25x3mm
Material	Aluminum 6068-T2
Connectors	Spigot

500 X 600 RECTANGLE

Span	m (ft)	4.00 (13.12)	6.00 (19.69)	8.00 (26.25)	10.00 (32.81)	12.00 (39.37)	14.00 (45.93)	16.00 (52.49)
Point load	kg (lbs)	1860 (4100)	1737 (3829)	1650 (3637)	1342 (2958)	1131 (2493)	976 (2151)	843 (1858)
Deflection	mm (in)	2.4 (0.09)	7.4 (0.29)	16 (0.62)	28 (1.10)	45 (1.88)	67 (2.63)	93 (3.66)
Distrib. loading	kg (lbs)	788 (1737)	698 (1538)	655 (1444)	588 (1296)	468 (1031)	379 (835)	169 (372)
Deflection	mm (in)	6.6 (0.25)	20.9 (0.82)	36 (1.41)	57 (2.24)	81 (3.18)	107 (4.21)	137 (5.39)

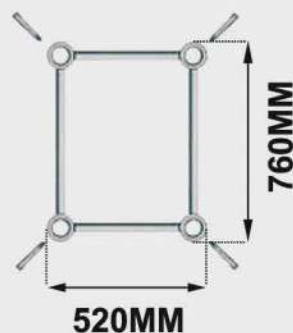
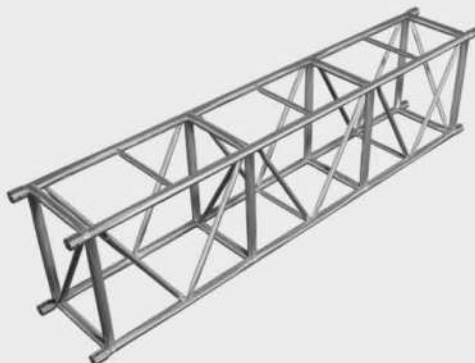

TECHNICAL DATA

Pipe diameter	50mm
Wall thickness	4,0mm
Brace diameter	25x3mm
Material	Aluminum 6068-T2
Connectors	Spigot

520 X 760 RECTANGLE

Span	m (ft)	4.00 (13.12)	6.00 (19.69)	8.00 (26.25)	10.00 (32.81)	12.00 (39.37)	14.00 (45.93)	16.00 (52.49)
Point load	kg (lbs)	3478 (7667)	3166 (6870)	2478 (5464)	1968 (4339)	1620 (3572)	1365 (3009)	1168 (2575)
Deflection	mm (in)	2.4 (0.09)	8.8 (0.3)	16.7 (0.7)	26.4 (1.0)	38.5 (1.5)	52.8 (2.1)	69.6 (2.7)
Distrib. loading	kg (lbs)	899 (1981)	713 (1571)	530 (1168)	394 (868)	270 (595)	195 (429)	146 (321)
Deflection	mm (in)	6.6 (0.25)	7.3 (0.3)	17.3 (0.7)	31.7 (1.2)	46.1 (1.8)	63.4 (2.5)	83.6 (3.3)

M 300

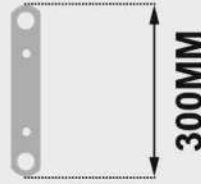

TECHNICAL DATA

Pipe diameter	50mm
Wall thickness	2,0mm
Brace diameter	
Material	Aluminum 6068-T2
Connectors	Bolt

300 LADDER

Span	m (ft)	3.00 (9.84)	4.00 (13.12)	5.00 (16.40)	6.00 (19.69)	7.00 (22.97)	8.00 (26.25)	9.00 (29.53)
Point load	kg (lbs)	586.2 (1292.34)	501.0 (1104.5)	398.1 (877.6)	329.0 (725.3)	279.2 (615.5)	241.5 (532.4)	211.8 (466.9)
Deflection	mm (in)	5 (0.19)	11 (0.43)	17 (0.66)	24 (0.94)	32 (1.25)	42 (1.65)	54 (2.12)
Distrib. loading	kg (lbs)	377.0 (831.1)	250.5 (552.2)	159.2 (350.9)	109.7 (241.8)	79.8 (175.9)	241.5 (133.1)	47.1 (103.8)
Deflection	mm (in)	8 (0.23)	13 (0.51)	21 (0.82)	30 (1.18)	40 (1.57)	51 (2.00)	69 (2.71)

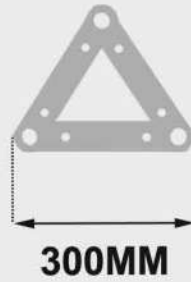

TECHNICAL DATA

Pipe diameter	50mm
Wall thickness	2,0mm
Brace diameter	
Material	Aluminum 6068-T2
Connectors	Bolt

300 TRIANGLE

Span	m (ft)	4.00 (13.12)	6.00 (19.69)	8.00 (26.25)	10.00 (32.81)	12.00 (39.37)	14.00 (45.93)	16.00 (52.49)
Point load	kg (lbs)	411.4 (906.9)	279.3 (615.7)	202.5 (446.4)	154.8 (341.2)	121.6 (268.0)	96.9 (213.6)	77.3 (170.4)
Deflection	mm (in)	9 (0.35)	21 (0.82)	37 (1.45)	58 (2.28)	84 (3.30)	114 (4.48)	148 (5.82)
Distrib. loading	kg (lbs)	215.0 (473.9)	93.1 (205.2)	50.6 (111.5)	31.0 (68.3)	20.3 (44.7)	13.8 (30.4)	10.0 (22.0)
Deflection	mm (in)	13 (0.51)	26 (1.02)	47 (1.85)	73 (2.87)	105 (4.13)	143 (5.62)	184 (6.45)

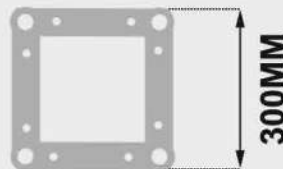

TECHNICAL DATA

Pipe diameter	50mm
Wall thickness	2,0mm
Brace diameter	
Material	Aluminum 6068-T2
Connectors	Bolt

300 SQUARE

Span	m (ft)	4.00 (13.12)	6.00 (19.69)	8.00 (26.25)	10.00 (32.81)	12.00 (39.37)	14.00 (45.93)	16.00 (52.49)
Point load	kg (lbs)	629.0 (1386.7)	520.8 (1148.1)	444.3 (979.5)	385.2 (849.2)	313.6 (691.3)	261.4 (576.2)	221.2 (487.6)
Deflection	mm (in)	8 (0.31)	17 (0.66)	39 (1.53)	65 (2.55)	93 (3.66)	119 (4.68)	151 (5.94)
Distrib. loading	kg (lbs)	502.5 (1107.8)	221.0 (487.2)	122.0 (268.9)	76.0 (167.5)	51.0 (112.4)	36.0 (79.3)	27.0 (59.5)
Deflection	mm (in)	12 (0.47)	30 (1.18)	52 (2.04)	80 (3.14)	111 (4.37)	161 (6.33)	213 (8.38)

M 305

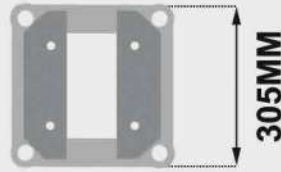
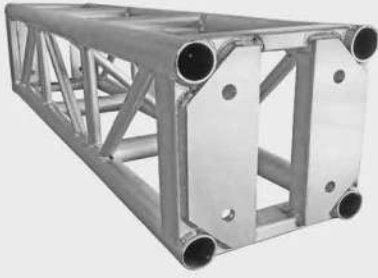

TECHNICAL DATA

Pipe diameter	50mm
Wall thickness	2,0mm
Brace diameter	
Material	Aluminum 6068-T2
Connectors	Bolt

305 SQUARE

Span	m (ft)	3.00 (9.84)	4.00 (13.12)	5.00 (16.40)	6.00 (19.69)	7.00 (22.97)	8.00 (26.25)	9.00 (29.53)
Point load	kg (lbs)	922 (2033)	850 (1873)	678 (1494)	571 (1259)	508 (1119)	405 (892)	353 (778)
Deflection	mm (in)	5 (0.19)	11 (0.43)	17 (0.66)	24 (0.94)	32 (1.25)	42 (1.65)	54 (2.12)
Distrib. loading	kg (lbs)	605 (1333)	430 (947)	265 (584)	187 (412)	150 (330)	98 (216)	77 (169)
Deflection	mm (in)	8 (0.23)	13 (0.51)	21 (0.82)	30 (1.18)	40 (1.57)	51 (2.00)	69 (2.71)

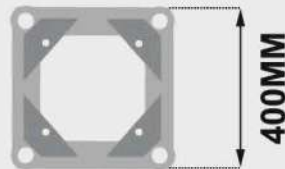

TECHNICAL DATA

Pipe diameter	50mm
Wall thickness	3,0mm
Brace diameter	25x2mm
Material	Aluminum 6068-T2
Connectors	Bolt

400 SQUARE

Span	m (ft)	4.00 (13.12)	6.00 (19.69)	8.00 (26.25)	10.00 (32.81)	12.00 (39.37)	14.00 (45.93)	16.00 (52.49)
Point load	kg (lbs)	478.4 (1054.6)	430.6 (949.3)	391.6 (863.3)	359.0 (791.0)	331.5 (730.8)	307.8 (678.5)	287.3 (633.3)
Deflection	mm (in)	2.4 (0.09)	7.4 (0.29)	16 (0.62)	28 (1.10)	45 (1.88)	67 (2.63)	93 (3.66)
Distrib. loading	kg (lbs)	518 (1141.9)	324 (714.2)	181 (399.0)	114 (251.3)	78 (171.9)	56 (123.4)	42 (92.5)
Deflection	mm (in)	6.6 (0.25)	20.9 (0.82)	36 (1.41)	57 (2.24)	81 (3.18)	107 (4.21)	137 (5.39)

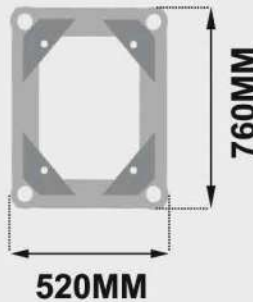

TECHNICAL DATA

Pipe diameter	50mm
Wall thickness	4,0mm
Brace diameter	30x3mm
Material	Aluminum 6068-T2
Connectors	Bolt

520 X 760 RECTANGLE

Span	m (ft)	4.00 (13.12)	6.00 (19.69)	8.00 (26.25)	10.00 (32.81)	12.00 (39.37)	14.00 (45.93)	16.00 (52.49)
Point load	kg (lbs)	3478 (7667)	3166 (6870)	2478 (5464)	1968 (4339)	1620 (3572)	1365 (3009)	1168 (2575)
Deflection	mm (in)	2.4 (0.09)	8.8 (0.3)	16.7 (0.7)	26.4 (1.0)	38.5 (1.5)	52.8 (2.1)	69.6 (2.7)
Distrib. loading	kg (lbs)	899 (1981)	713 (1571)	530 (1168)	394 (868)	270 (595)	195 (429)	146 (321)
Deflection	mm (in)	6.6 (0.25)	7.3 (0.3)	17.3 (0.7)	31.7 (1.2)	46.1 (1.8)	63.4 (2.5)	83.6 (3.3)

SPIGOT CORNER

CRAZY
T R E N D

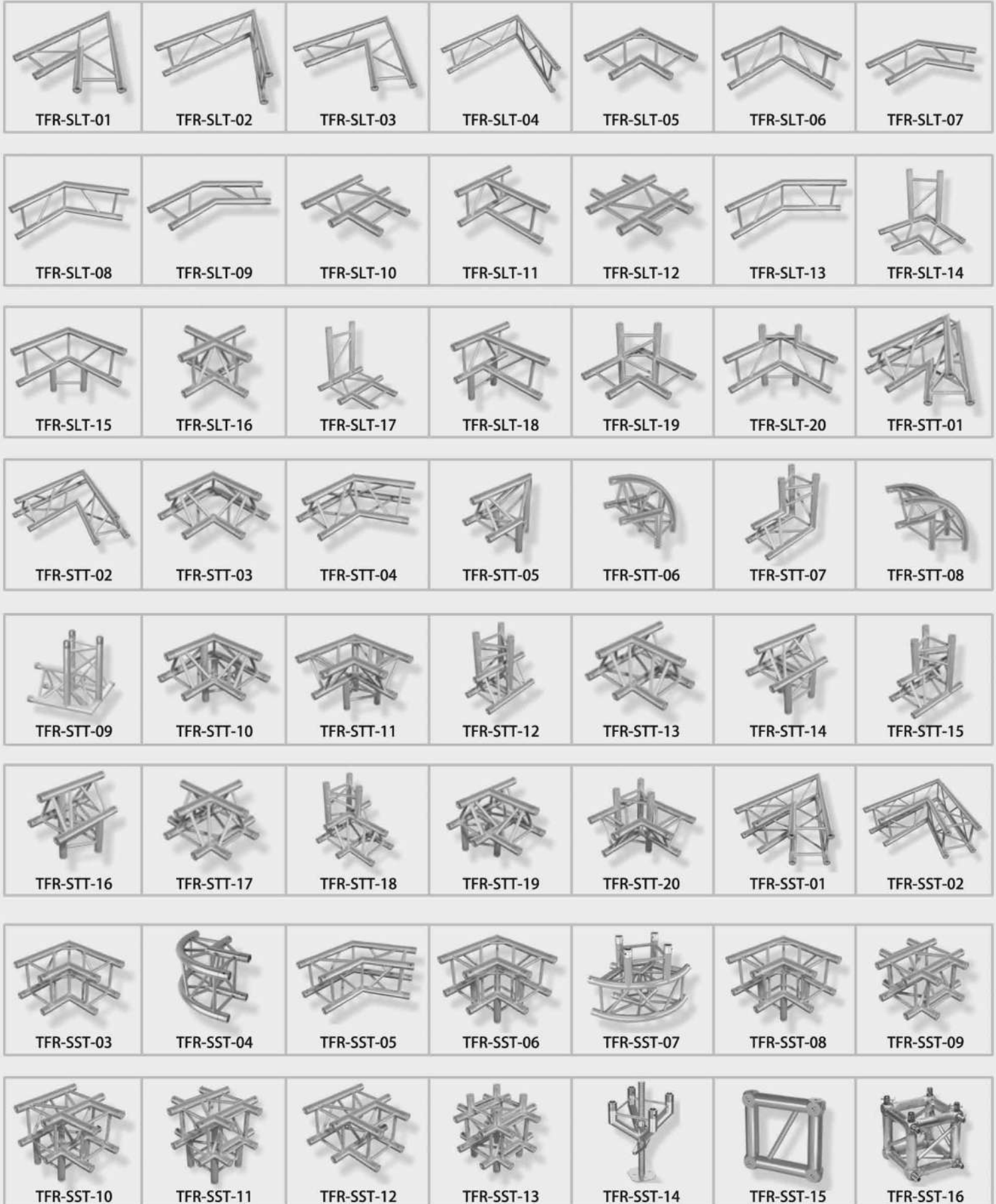





TRUSS CLAMPS



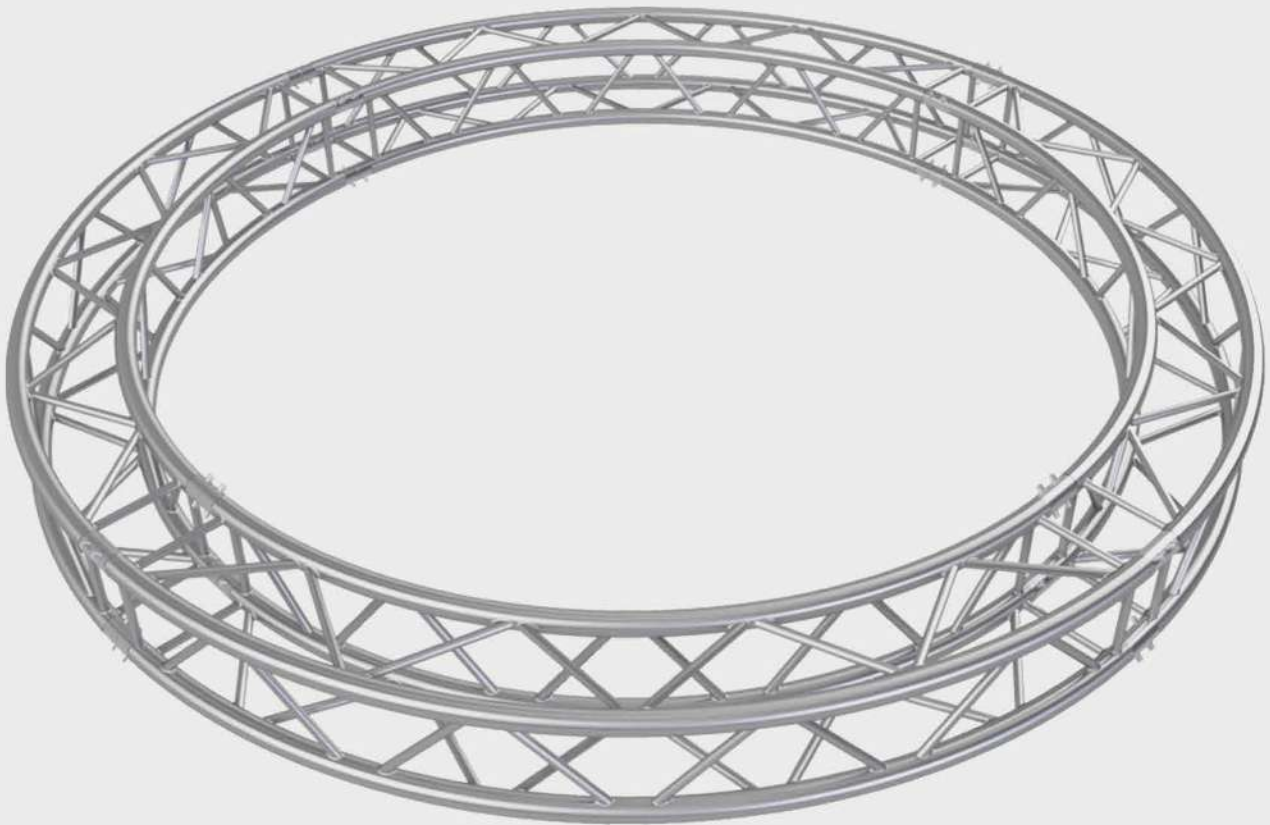

TFR CIRCLE TRUSS

has unilateral shape, such as triangle and quadrilateral. Usually with diameters ranging from 1-4 m. For the load and shape of a circle, the size of pipe will be varied.

Structure is divided into: Screw and spigot, other irregular shape can be customized according to the customers' requirement.

TFR-CIRCULAR- LADDER



TFR-CIRCULAR- TRIANGLE



TFR-CIRCULAR- SQUARE



TFR-CIRCULAR- OVAL

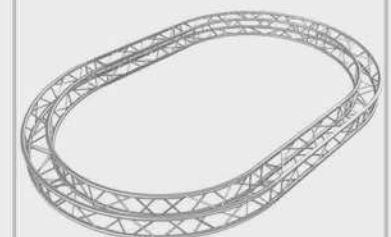



TFR GANTRY TRUSS

best suited for advertising presentations.
Take advantage of this flexible framework for banners or just fix a screen for video presentations.

SLEEVE BLOCK	BASE	TOP SECTION
		
TRUSS	HINGE SECTION	OUTRIGGER
		

TFR GANTRY TRUSS SYSTEM

is one of the best-selling products in our company. It is easy to transport and easy to install, and it is favored by many event service companies.

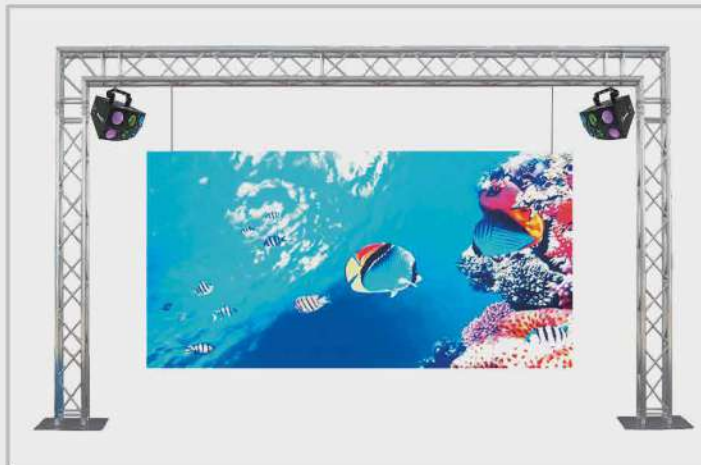

TFR-GTS-01



TFR-GTS-02



TFR-GTS-03

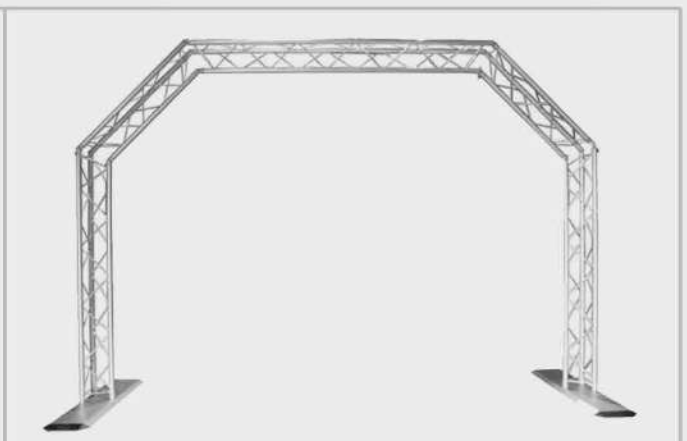

TFR-GTS-04

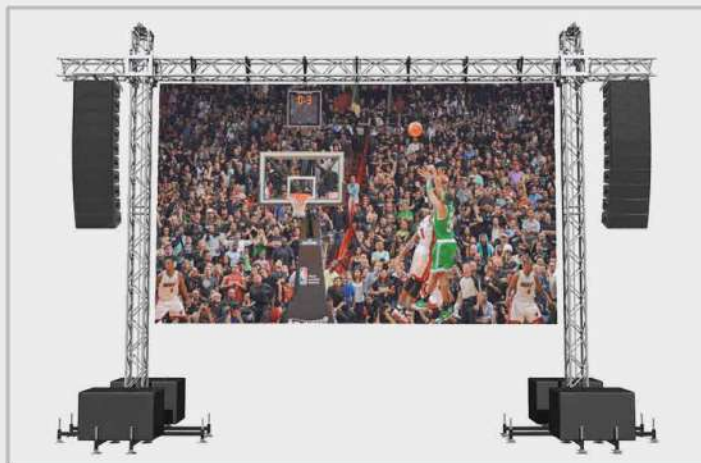

CLIENT FEEDBACK

TFR rigging tower . Suitable for various kinds of application, e.g. outdoor events, concerts, shopping malls, entrance halls, exhibitions, displays, theme parks and corporate events.



BASE	TOP SECTION
	
HINGE SECTION	OUTRIGGER
	
SLEEVE BLOCK	TRUSS
	

TFR rigging towers have wide range of applications. There are two basic kinds of TFR rigging tower systems. The towers used as supportive stands for various grids (e.g. in roof systems or large span structures) and towers used as a support of speakers.

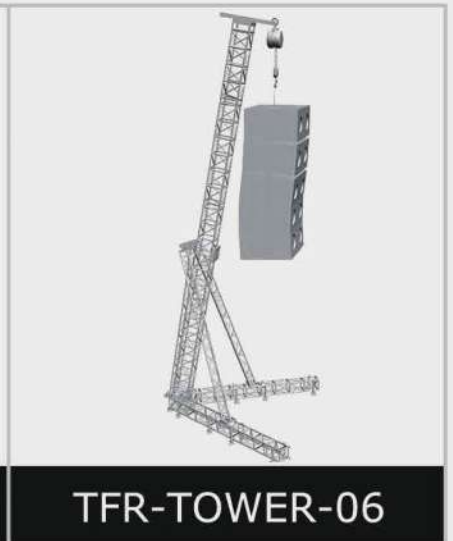
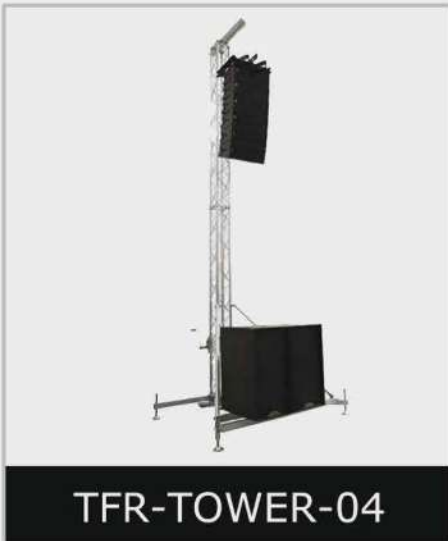
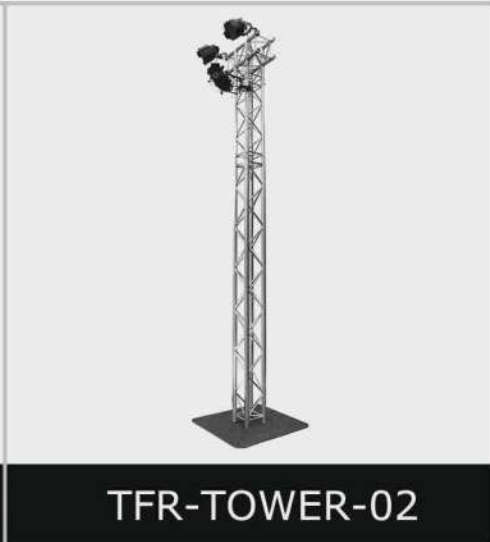
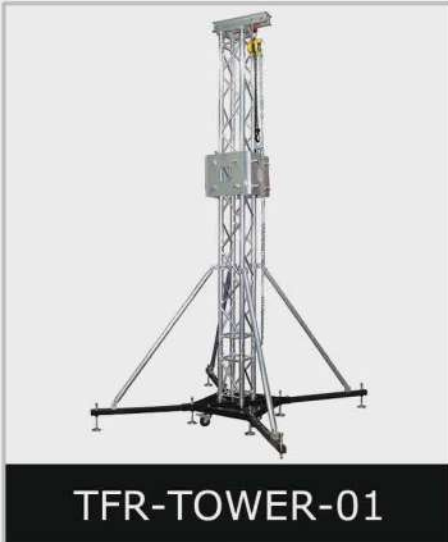

CLIENT FEEDBACK



TFR TOTEM TRUSS

is a professional high tech design upright display structure that is simple to set up, built rock solid and requires no additional support. Place lights inside or outside the truss framework depending on your needs. Use in conjunction with Truss Covers to create an eye catching, dramatic lighting display that will leave your crowd in awe! Totems can also be used for mounting video screens used in sports bars and more.

Totems are ideal for clubs, bars, hotels, weddings/formal events and restaurants. Features include: Industrial grade trussing and sturdy baseplate for optimum support.

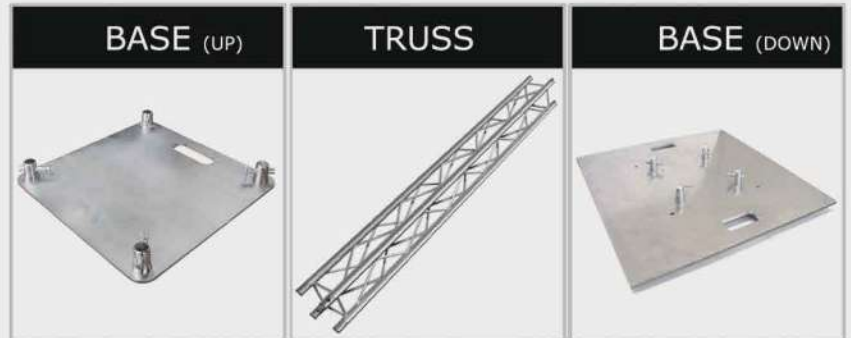

TFR NINJA TRUSS

challenge and improve the strength, endurance, coordination, agility and balance of young and adults alike. They are a fun activity that allows participants to train, compete and unwind in a safe environment.



TFR-NINJA-01

TFR-NINJA-02

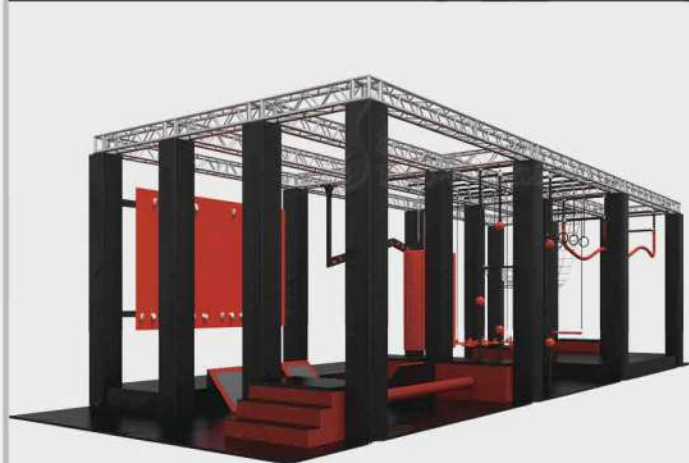

TFR-NINJA-03

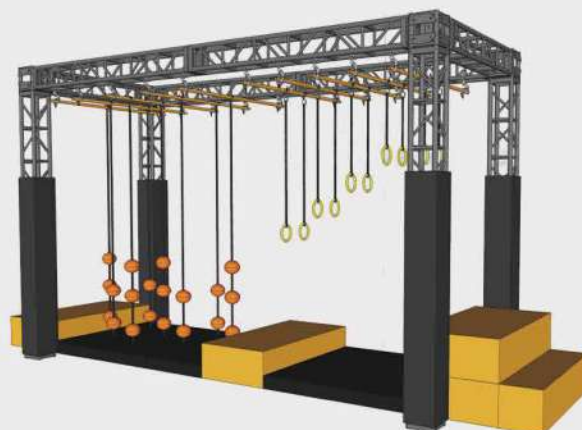

Applicable truss specification: 220x220mm 250x250mm
290x290mm

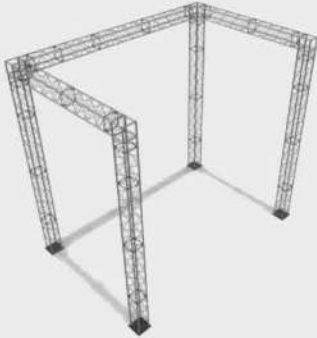

TFR-ET-01

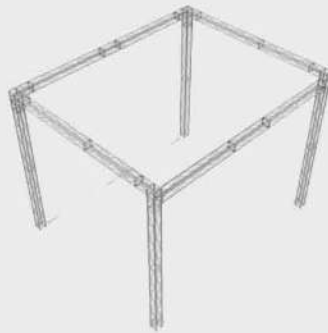

TFR-ET-02

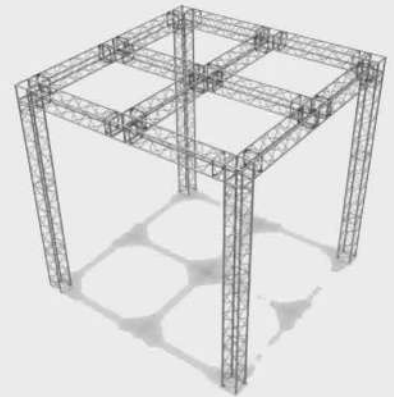

TFR-ET-03

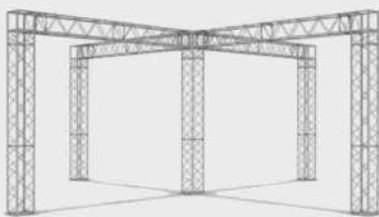

TFR-ET-04

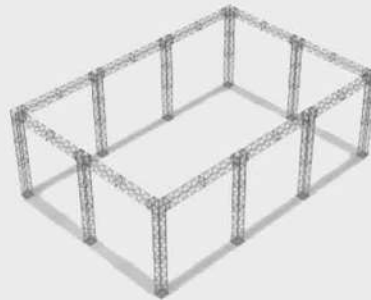

TFR-ET-05

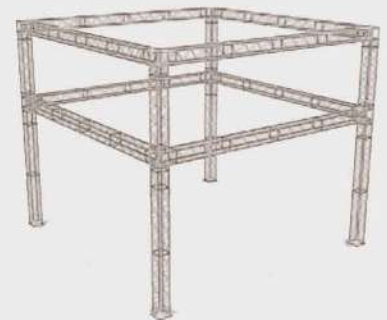

TFR-ET-06



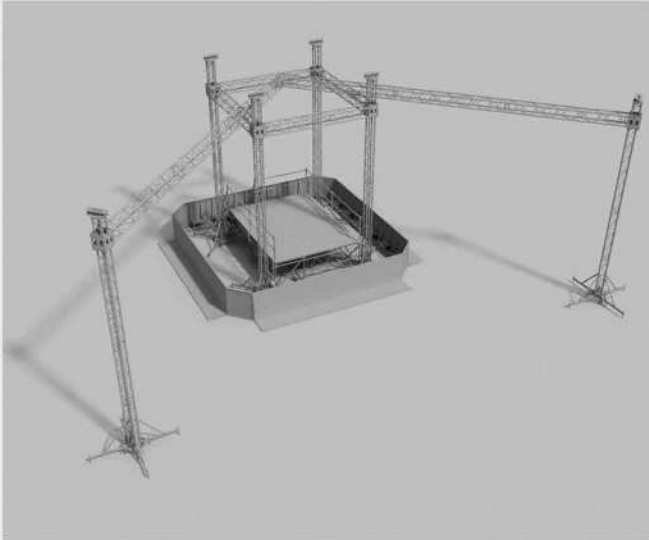

TFR-TS-01

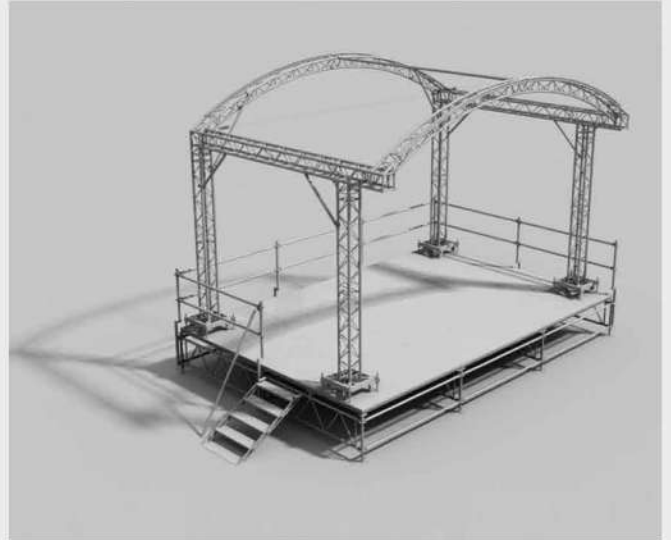

TFR-TS-02

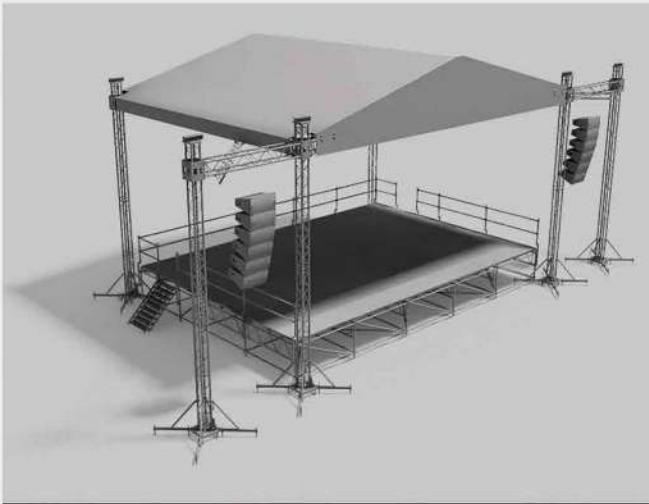

TFR-TS-03

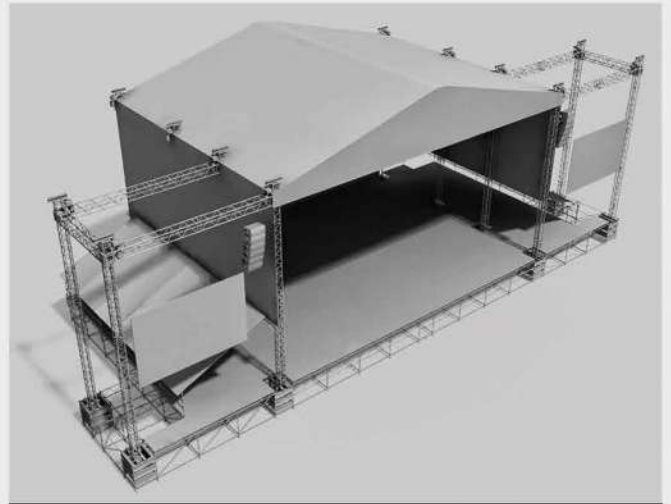

TFR-TS-04



TFR-TS-04

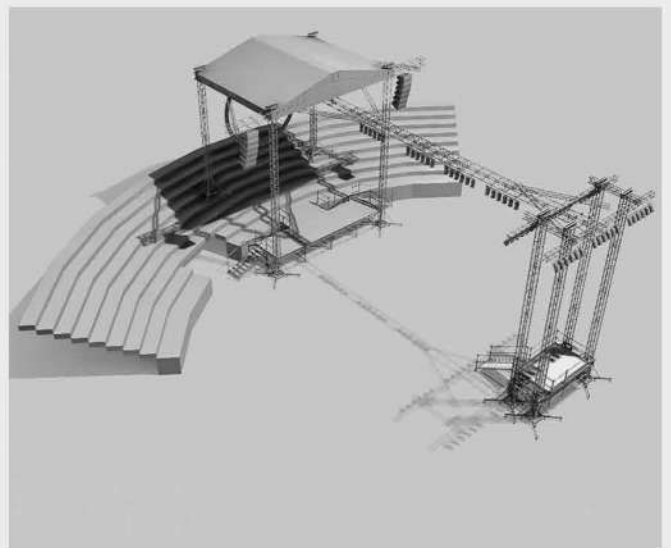

TFR-TS-06



SPECIFICATION

Frame material	Aluminum 6082-T6
Top board material	Plywood thick 18mm, Carpet, Plexiglass, Toughened glass
Load capacity	750kg/㎡
Tube size	50x3mm 43x2mm 25x2mm ...
Platform size	1x1m 1x2m 1.22x1.22m 1.22x2.44m
Leg height	0.4-0.6m 0.6-1.0m 0.8-1.2m 1.0-1.5m 1.5-2.0m

STAGE COMPONENT

Aluminum stage is a simple and effective support frame for indoor or outdoor used, to create a raised stage floor. The frame racks are available in several heights and lengths, creating an interconnected framework that can act as ballast system for your roof construction. Can absorb vertical as well as horizontal forces.







SPECIFICATION

Frame material	Aluminum 6082-T6
Top board material	Plywood thick 18mm, Carpet, Plexiglass, Toughened glass
Load capacity	750kg/㎡
Tube size	50x3mm 43x2mm 25x2mm ...
Platform size	1x1m 1x2m 1.22x1.22m 1.22x2.44m
Leg height	0.4-0.6m 0.6-1.0m 0.8-1.2m 1.0-1.5m 1.5-2.0m

STAGE COMPONENT

Classical stage is a easy install and stable support frame for indoor or outdoor used, to create a raised stage floor. The frame racks are available is several heights and lengths, creating an interconnected framework that can act as ballast system for your roof construction. Can absorb vertical as well as horizontal forces.







SPECIFICATION

Frame material	Aluminum 6082-T6
Top board material	19mm black coated birch plywood
Load capacity	750kg/㎡
Platform size	1x1m 1x2m 1.22x1.22m (4ftx4ft) 1.22x2.44m (4ftx8ft) 1.22x1.83m (4ftx6ft) 0.61x2.44m (2ftx8ft)
Leg height	16.5cm 35.5cm 54.5cm 73.5cm 92.5cm or make customized height.

STAGE COMPONENT

Easy stage is a easy install and stable support frame for indoor or outdoor used, to create a raised stage floor. It is a lightweight yet robust staging solution that can be relied upon to perform. The Easy stage system is available in a wide range of shapes and sizes, allowing hundreds of stage configurations to be created from a relatively narrow stock of standard components



FOLDING STAGE



HOTEL STAGE

SPECIFICATION

Frame material	Steel and Paint
Structure material	5mm thickness steel angle, 35mm diameter circular tube composite board, fire carpet
Load capacity	2.5T/㎡
Platform size	1.22x2.44m 1.83x2.44m
Leg height	0.4-0.6m 0.6-0.8m



X FOLDING STAGE

SPECIFICATION

Frame material	Steel and Paint
Structure material	5mm thickness steel angle, 35mm diameter circular tube composite board, fire carpet
Load capacity	2.5T/㎡
Platform size	1.22x2.44m 1.83x2.44m
Leg height	0.4-0.6m 0.6-0.8m





TFR-TS-01

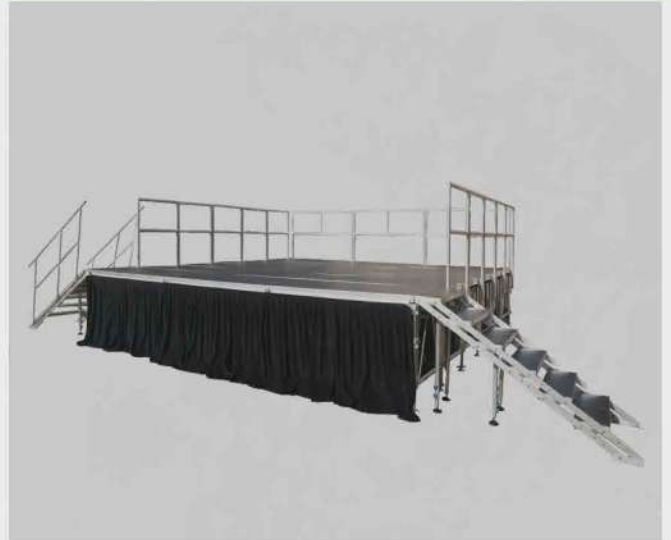

TFR-TS-02



TFR-TS-03



TFR-TS-04

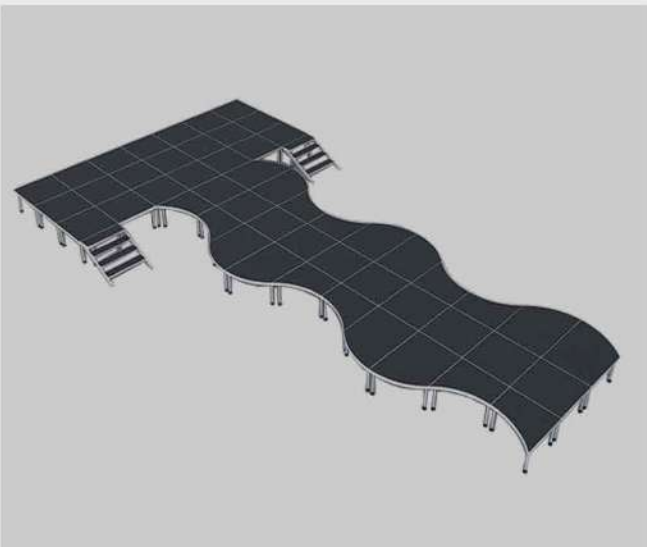

TFR-TS-04



TFR-TS-06



Pipe and Drape refers to pipe, fixed or adjustable telescoping vertical uprights supported by a weighted steel base, and adjustable telescopic or fixed horizontals that provide a drape support frame with removable drape panels. Pipe and Drape is used to divide, hide, and/or decorate a space temporarily.

When the system is used for exhibition purposes and used instead of the traditional shell scheme option build time and breakdown time is significantly reduced. Pipe and drape is a great way of adding colour to what would normally be a relatively plain backdrop.

FRAME COMPONENT

1. ADJUSTABLE CROSSBAR

Feet	Meter	Feet	Meter
2'-3'	0.6-0.9	7'-12'	2.1-3.6
3'-5'	0.9-1.5	8'-14'	2.4-4.2
4'-7'	1.2-2.1	9'-16'	2.7-4.8
5'-8'	1.5-2.4	10'-18'	3.0-5.4
6'-10'	1.8-3.0	8'-10'	2.4-3.0(three-section)

2. ADJUSTABLE UPRIGHT

Two-Sections Uprights		Three-Sections Uprights	
Feet	Meter	Feet	Meter
3'-5'	0.91-1.5	5'-11'	1.5-3.3
4'-7'	1.2-2.1	6'-14'	1.8-4.2
5'-8'	1.5-2.4	7'-17'	2.1-5.1
6'-10'	1.8-3.0	8'-20'	2.4-6.0
7'-12'	2.1-3.6	9'-23'	2.7-7.0
8'-14'	2.4-4.2		
9'-16'	2.7-4.8		

3. BASE PLATE (WITH SPIGOT)

Feet	Meter
18"x18"x3/16"	450*450*5mm
18"x18"x5/16"	450*450*8mm
18"x18"x3/8"	450*450*10mm
24"x24"x3/16"	600*600*5mm
24"x24"x5/16"	600*600*8mm
24"x24"x3/8"	600*600*10mm
20"x20"x3/16"	500*500*5mm



4. DRAPE FABRIC (SIZE CAN BE CUSTOMIZED)



Pipe & Drape 1.0

Upright Tube: $\varnothing 50*1.6\text{mm}$, $\varnothing 45*1.5\text{mm}$, $\varnothing 40*1.3\text{mm}$
& Surface Anodizing.

Crossbar Tube: $\varnothing 35*1.4\text{mm}$, $\varnothing 39*1.4$ & Surface Anodizing.



ADJUSTABLE UPRIGHT



ADJUSTABLE CROSSBAR



BASE PLATE



SPIGOT



ADJUSTABLE UPRIGHT



ADJUSTABLE CROSSBAR



BASE PLATE



SPIGOT



Pipe & Drape 2.0

Upright Tube: $\varnothing 50*1.6\text{mm}$, $\varnothing 45*1.5\text{mm}$, $\varnothing 40*1.3\text{mm}$
& Surface Anodizing.

Crossbar Tube: $\varnothing 35*1.4\text{mm}$, $\varnothing 39*1.4$ & Surface Anodizing.

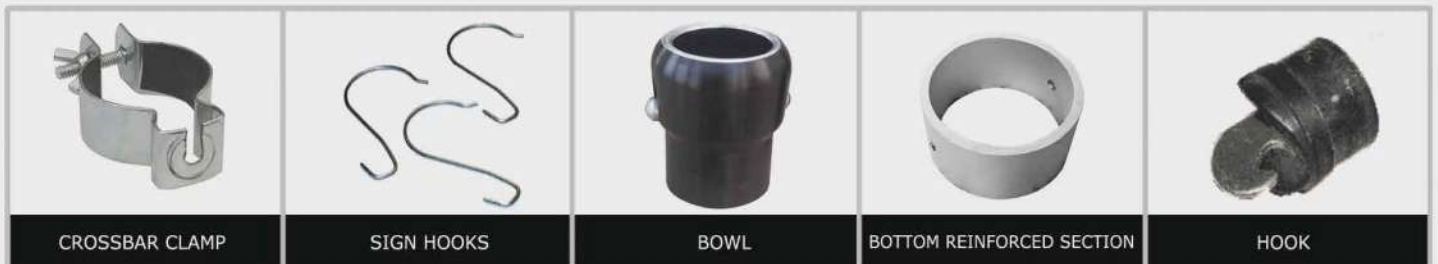



Velvet, Polyester, Ice Silk, Chiffon

Widely used for Home Theatre, Recording Studios, Corporate Events, Theatrical Stages, Weddings, Club/Bars/Lounges, Special Event Decor, Churches/Schools, Shop, Demo Rooms.



Velvet



Polyester



Ice Silk



Chiffon



TFR-PAD-01



TFR-PAD-02



TFR-PAD-03



TFR-PAD-04

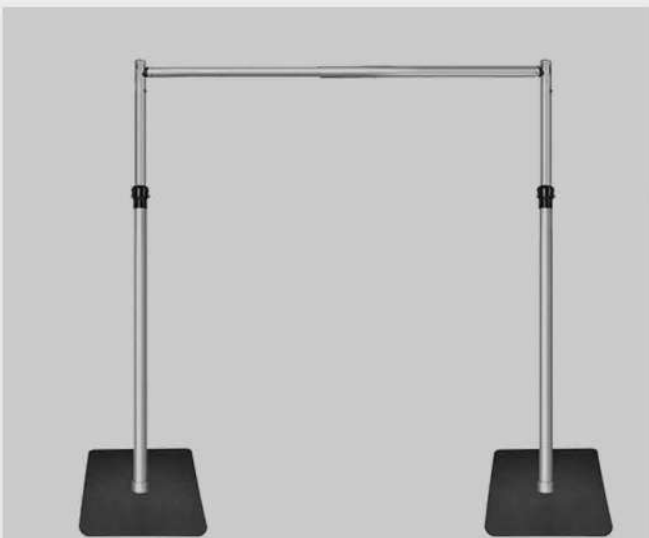

TFR-PAD-05

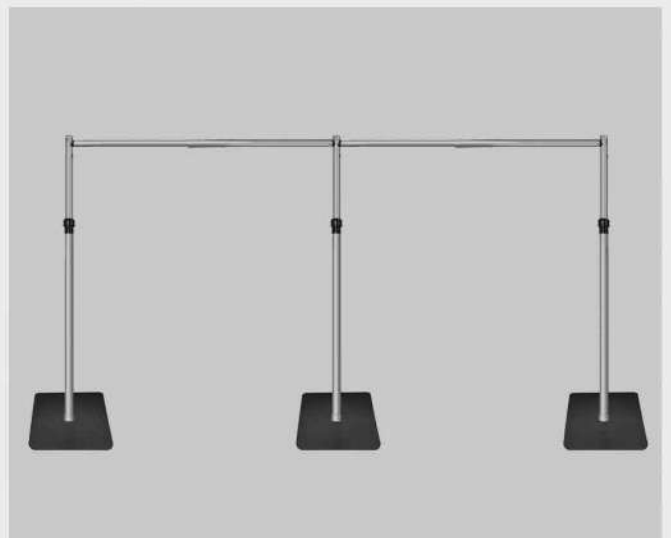

TFR-PAD-06

Led 3D Dance floor

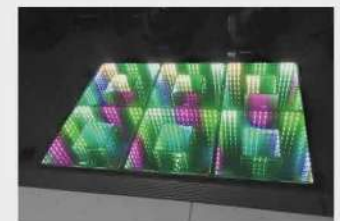
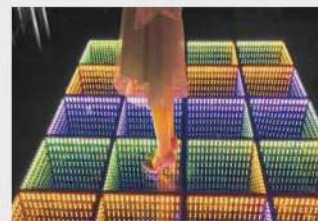
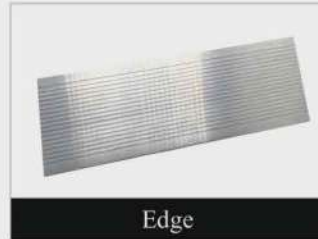
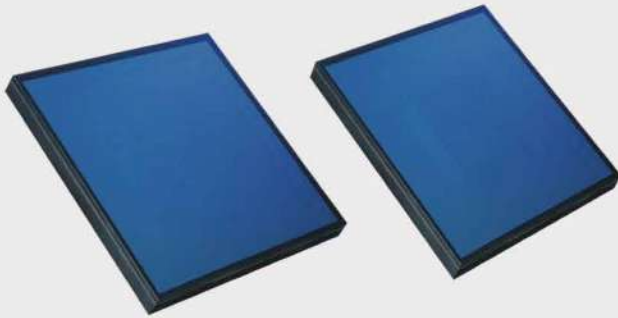

Main Specification:

Input voltage	AC100-260V 50-60Hz
Maximum power	12W/15W
Light source	5050RGB 3in1
Service life	≥ 50000h
Control mode	SD or PC controller
Product specification	L500*W500*H70mm
Net weight	10kg/11.2kg
Panel material	Crystal toughened glass
Base material	High strength ABS
Bear weight	500kg/ m ²
Working temperature	-20°C/45°C
Protection grade	IP55/IP65

Features:

- High gloss, interlocking panels
- Cool white or RGB LEDs
- Aluminum edge trim
- RF remote control with static and adjustable rate flash and twinkle

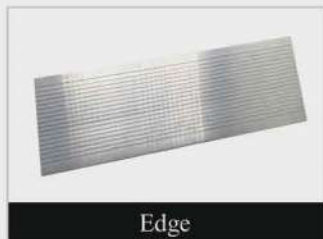

Led Digital Dance floor



Main Specification:

Input voltage	AC 100-260V/50-60Hz
Maximum power	24w
Light source	5050RGB 3in1
Service life	≥ 50000h
Control mode	SD or PC controller
Product specification	L500-W500*H700mm
Net weight	8.8kg
Panel material	Crystal toughened glass
Base material	High strength ABS
Bear weight	500kg/ m ²
Working temperature	-20°C/45°C
Protection grade	IP55/IP65

Application:

- KTV, Bar corridor, T stage,
- Shoppng corridor,
- Production conference,
- Huge party, Concert, etc.

Led Liquid Dance floor

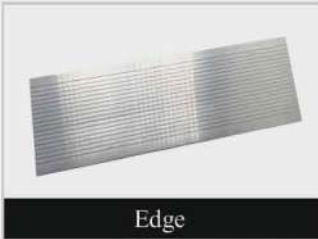

Edge



Power Supply

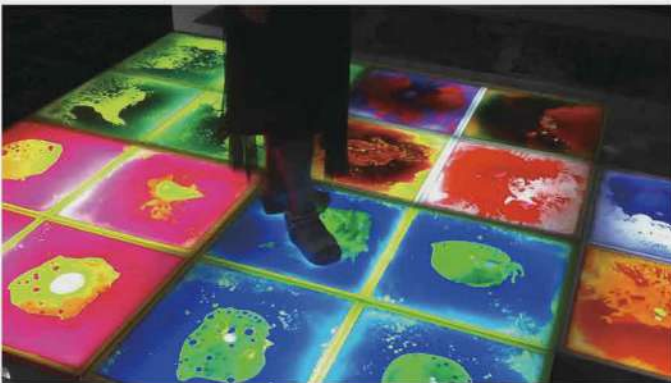

Main Specification:

Input voltage	AC90-277V
Maximum power	13W/30W
Light source	5050RGB 3in1
Service life	≥ 50000h
Control mode	No
Product specification	L500*W500*H60mm
Net weight	9kg
Panel material	10mm Tempered glass
Base material	High strength ABS
Bear weight	500kg/㎡
Working temperature	-20℃/45℃
Protection grade	IP54/IP67

Features:

- High gloss, interlocking panels
- Cool white or RGB LEDs
- Aluminum edge trim
- RF remote control with static and adjustable rate flash and twinkle

Led Video Dance floor

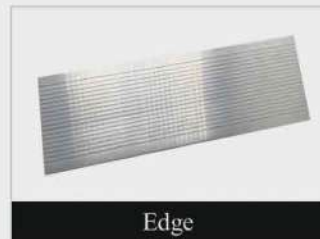

Edge



Power Supply

Main Specification:

Input voltage	AC 100-260V/50-60Hz
Maximum power	20w
Light source	3528SMD 3in1
Service life	≥ 50000h
Control mode	SD or PC controller
Product specification	L400-W400*H700mm
Net weight	9kg
Panel material	Translucent acrylic glass
Base material	Aluminum alloy sheet
Bear weight	500kg/㎡
Working temperature	-20℃/45℃
Protection grade	IP55

Application:

- KTV, Bar corridor, T stage,
Shoppng corridor,
Production conference,
Huge party, Concert, etc.



Controller



SD Controller





SPECIFICATION

Name	2 Channel Cable Ramp
Feature	2 Channel
Material	Rubber
Size	1000x250x250mm
Dimension	32*35mm
Packing	Woven
Capacity	15 Tons-40°F to131°F
Application	Road/Square/Show/Concert

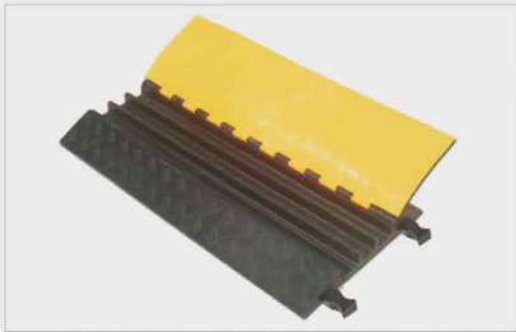

SPECIFICATION

Name	3 Channel Cable Ramp
Feature	3 Channel
Material	Rubber
Size	1000x310x550mm
Dimension	32*35mm
Packing	Woven
Capacity	15 Tons-40°F to131°F
Application	Road/Square/Show/Concert



SPECIFICATION

Name	4 Channel Cable Ramp
Feature	4 Channel
Material	Rubber
Size	770x485x65mm
Dimension	40*40mm
Packing	Woven
Capacity	15 Tons-40°F to131°F
Application	Road/Square/Show/Concert



SPECIFICATION

Name	5 Channel Cable Ramp
Feature	5 Channel
Material	Rubber
Size	900x500x50mm
Dimension	32*35mm
Packing	Woven
Capacity	15 Tons-40°F to131°F
Application	Road/Square/Show/Concert



SPECIFICATION

Name	Cable Ramp Corner
Feature	2 Channel
Material	Rubber
Dimension	32*35mm
Packing	Woven
Capacity	15 Tons-40°F to131°F
Application	Road/Square/Show/Concert



CROWD CONTROL BARRIERS

(ALSO REFERRED TO AS CROWD CONTROL BARRICADES, WITH SOME VERSIONS CALLED A FRENCH BARRIER OR BIKE RACK IN THE USA), ARE COMMONLY USED AT MANY PUBLIC EVENTS. THEY ARE FREQUENTLY VISIBLE AT SPORTING EVENTS, PARADES, POLITICAL RALLIES, DEMONSTRATIONS, AND OUTDOOR FESTIVALS. EVENT ORGANIZERS, VENUE MANAGERS, AND SECURITY PERSONNEL USE BARRICADES AS PART OF THEIR CROWD MANAGEMENT PLANNING.



CORNER



FRONT



BACK



GATE



CLOSE



CRAZY TREND

WWW.CRAZYTREND.ES
info@crazytrend.es

